

VENETIAN WATERWAY PARK

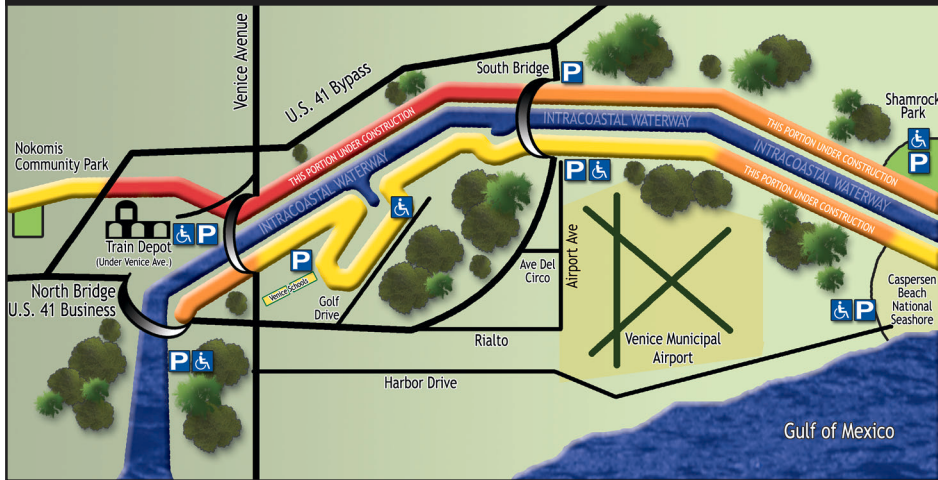

The Venetian Waterway Park is open for walking, bike riding, and rollerblading. Portions of the park are paved, while “under construction areas” are “rough terrain” areas available for hiking and mountain biking.

- Paved Trail
- Under Construction
(Current Fund-Raising Target Area)
- Under Construction

- P Parking
- ♿ Handicap Accessible Parking

P VENETIAN WATERWAY PARK AVAILABLE PARKING

- Southwest side of the U.S. 41 north bridge
- Train Depot beneath Venice Ave. bridge
- Behind Venice Elementary School
- Golf Drive (Handicap only)
- Southwest side of the U.S. 41 south bridge
- Airport Ave Parking (down dirt road)
- Shamrock Park & Caspersen Beach parking lot